



Accessories Installation Instructions

Cord Seals, Cable Weight, Cable Clamp Assembly, and Float Bracket.

CORD SEALS



Provides strain relief and a liquid-tight seal.

- Seals 1-4 cables in 2" terminal adapters
- Seals 1-6 cables in 2½" terminal adapters
- PVC plugs included (for unused cable positions)
- Ground wire

CABLE WEIGHT



U.S. Patent 5,306,885

Provides an accurate pivot point for suspended float switches.

- Gripper teeth on clip and weight channel securely lock float cable into place
- Cable Weight can be adjusted without the use of tools

CABLE CLAMP ASSEMBLY



Provides cable anchor point and strain relief. Secures cable in vertical direction.

- For use with 18/16 gauge, 14 gauge, & 12 gauge cable
- Mounting clamp: ABS Nylon blend
- Hose clamp: highly corrosion resistant stainless steel

FLOAT BRACKET

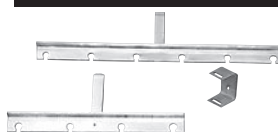

Provides convenient installation of float switches.

- Six Float Bracket supports 1-6 floats
- Four Float Bracket supports 1-4 floats
- Can be directly mounted to wall or used with wall mounting device
- Provides convenient location to stow excess float cord
- Supplied with cord strain relief connectors

PREVENTATIVE MAINTENANCE

- Periodically inspect the product. Check that the cable has not become worn or that the housing has not been damaged so as to impair the protection of the product. Replace the product immediately if any damage is found or suspected.
- Periodically check to see that the float is free to move and operate the pump or alarm.
- Use only SJE Rhombus® replacement parts.

SJE® FIVE-YEAR LIMITED WARRANTY

Five-Year Limited Warranty. For complete terms and conditions, please visit www.sjerrhombus.com.

NOTICE!

Products returned must be cleaned, sanitized, or decontaminated as necessary prior to shipment to ensure that employees will not be exposed to health hazards in handling said material. All applicable laws and regulations shall apply.

⚠ WARNING**ELECTRICAL SHOCK HAZARD**

Disconnect power before installing or servicing this product. A qualified service person must install and service this product according to applicable electrical and plumbing codes.

⚠ WARNING**EXPLOSION OR FIRE HAZARD**

Do not use this product with flammable liquids. Do not install in hazardous locations as defined by National Electrical Code, ANSI/NFPA 70.

Failure to follow these precautions could result in serious injury or death. Replace product immediately if switch cable becomes damaged or severed. Keep these instructions with warranty after installation. This product must be installed in accordance with National Electric Code, ANSI/NFPA 70 so as to prevent moisture from entering or accumulating within boxes, conduit bodies, fittings, float housing, or cable.

For detailed specifications on this product, or for the complete line of SJE® panel, alarm, and switch products, visit our web-sites at www.csicontrols.com, www.primexcontrols.com, or www.sjerhombus.com.

CORD SEAL INSTALL

1. Pass the cables through the 2" or 2½" terminal adaptor.
 2. Route cables through the seal, leaving adequate cable to work with. See Figure A.
- NOTE: If all hole positions are not used, plug open position(s) in the cord seal with the PVC plug(s) provided.**
3. Insert the cord seal into the terminal adaptor and tighten hex nut until adequate strain relief is achieved.
 4. Gather all ground wires, including ground conductor on the cord seal and secure to ground terminal.

CABLE WEIGHT INSTALL

1. Lay cable in weight as shown in Figure B.
2. Align clip with weight groove and slide clip towards cable as shown in Figure B. Snap clip snugly up to cable and manually force clip to tightest possible position.
3. See Figure C for proper tether length.

CABLE CLAMP INSTALL

1. Determine the required cord tether length according to product specifications.
 2. Place the cord into the clamp as shown as shown in Figure D.
 3. Locate clamp at desired activation level and secure the clamp to the discharge pipe as shown in Figure D.
- Note:** Do not install cord under hose clamp.
4. Tighten the hose clamp using screwdriver. Over tightening may result in damage to the plastic clamp. Make sure the float cable is not allowed to touch the excess hose clamp band during operation.
 5. Wire switch as shown in the Wiring Diagrams.
 6. Check installation. Allow system to cycle to insure proper operation.

Note: All hose clamp components are made of 18-8 stainless steel material. See your SJE® supplier for replacements.

FLOAT BRACKET INSTALL

1. Drill holes in mounting surface 1-5/16" apart vertically.
 2. Install the mounting bracket to the mounting surface using two fasteners as shown in Figure E.
- NOTE: Use stainless steel fasteners appropriate for the mounting surface.**
3. Snap the cord lock onto the cable shown in Figure E.
 4. Drop the cord lock and cord into the top side of a desired hole in the float bracket as shown in Figure F.
 5. Adjust the cord to the proper length, so that activation occurs at the desired level.
 6. To lock the cord in place, turn the cord lock clockwise as shown in Figure F.
 7. Slide the float bracket into the mounting bracket slots as shown in Figure F.
 8. Confirm the float cords are set at a proper height to insure correct activation/deactivation levels.

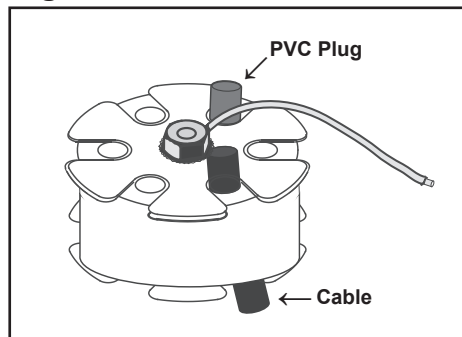
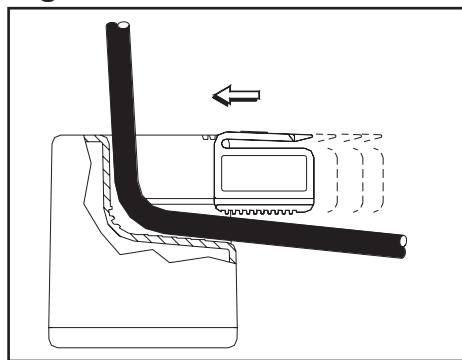
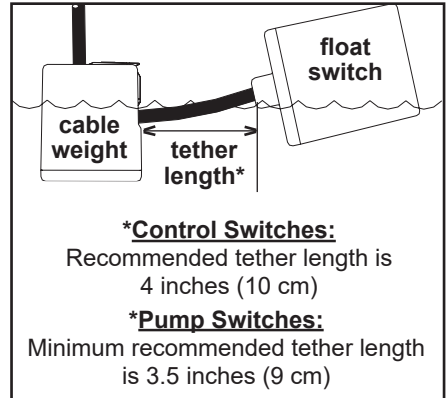
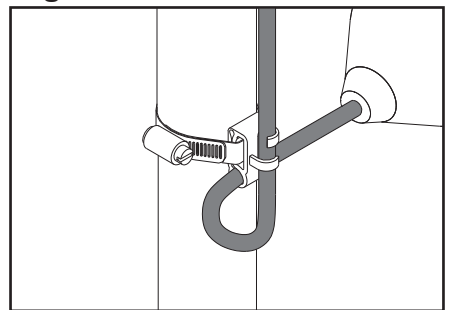
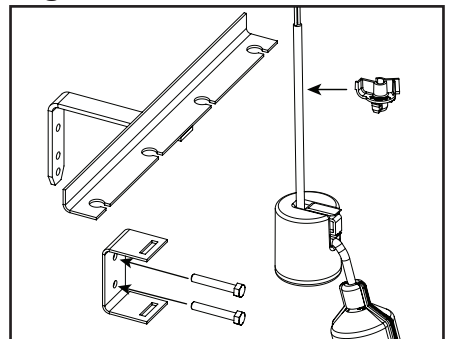
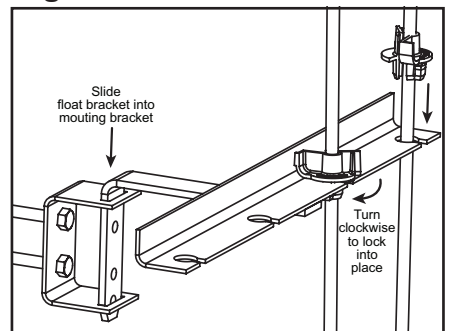
Figure A**Figure B****Figure C****Figure D****Figure E****Figure F**

Manufactured by: SJE Inc.
Technical support: +1-800-746-6287
techsupport@sjeinc.com

www.csicontrols.com

www.primexcontrols.com

www.sjerhombus.com