

SJE SIGNALMASTER® AND SJE SIGNALMASTER® SPDT CONTROL FLOATS

Mechanically-activated, narrow-angle float switches designed to activate pump control panels and alarms.

This narrow-angle sensing device is used to accurately monitor liquid levels in:

- Water
- Sewage applications

The **SJE SignalMaster®** control switch is not sensitive to rotation.

Normally Open Model (high level)

The control switch turns on (closes) when the switch tips slightly **above** horizontal signaling a high level, and turns off (opens) when the switch drops slightly below horizontal.

Normally Closed Model (low level)

The control switch turns on (closes) when the switch tips slightly **below** horizontal signaling a low level, and turns off (opens) when the switch tips slightly above horizontal.

SPDT = Single Pole Double Throw

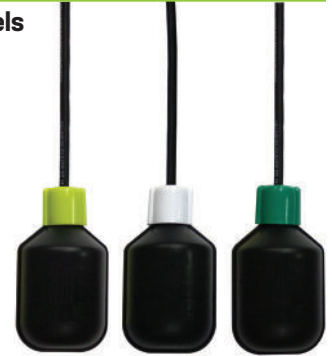

SPECIFICATIONS

- 125/250 VAC, 50/60 Hz, 5 Amps
- Flexible SJOW, water-resistant (CPE) cable
- High impact, corrosion resistant, polypropylene float housing
- Temperature rating up to 60° C (140° F)
- Maximum water depth of 9 meters (30 feet) or 90 kPa (13 psi)
- IPX8 enclosure protection
- Float dimensions: 7.0 cm diameter x 12.3 cm long (2.74 inch x 4.83 inch)
- Suitable for Category II installations
- Protected by double insulation
- Color coded for easy identification: yellow = normally open; white = normally closed; green = Single Pole Double Throw
- CE Certified units available upon request **CE**



Member of
Hydraulic

NOTE: These switches are not recommended for controlling electrical loads less than 100 milliamps, 12 VAC, or for non-arcing electrical loads.

MODEL SPECIFIC SPECIFICATIONS

SJE SIGNALMASTER® control float	
Cable:	18 gauge, 2 conductor

SJE SIGNALMASTER® SPDT control float	
Cable:	18 gauge, 3 conductor
Can be wired to operate in either normally open or normally closed applications. (S ingle P ole, D ouble T hrow)	

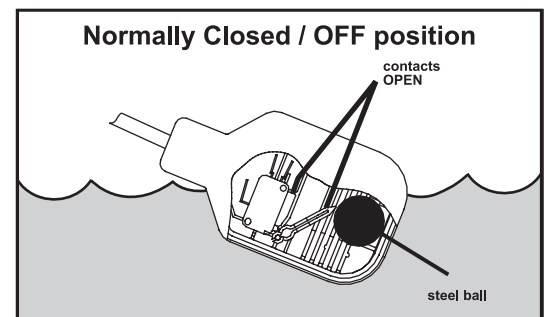
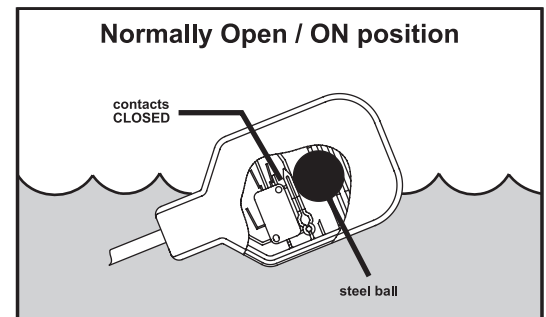

Control Floats



SJE RHOMBUS®

Phone: +1 218 847 1317
email: customer.service@sjeinc.com

www.sjerrhombus.com **E.7**

SEE BACK SIDE FOR COMPLETE LISTING OF AVAILABLE OPTIONS.

SJE SIGNALMASTER® AND SJE SIGNALMASTER® SPDT CONTROL FLOATS

Mechanically-activated, narrow-angle float switches designed to activate pump control panels and alarms.

ORDERING INFORMATION

SJE SIGNALMASTER® Control Float				
PART NUMBER		DESCRIPTION		SHIPPING WEIGHT
Normally Open	Normally Closed	Cable Length	Mounting Device	
1006075	1006080	3 Meters	Mounting Clamp	0.75 kg
1006085	1006090	3 Meters	Cable Weight	1.23 kg
1006076	1006081	5 Meters	Mounting Clamp	0.66 kg
1006086	1006091	5 Meters	Cable Weight	1.42 kg
1006077	1006082	6 Meters	Mounting Clamp	0.76 kg
1006087	1006092	6 Meters	Cable Weight	1.52 kg
1006078	1006083	10 Meters	Mounting Clamp	1.14 kg
1006088	1006093	10 Meters	Cable Weight	1.91 kg
SJE SIGNALMASTER® SPDT Control Float				
PART NUMBER		DESCRIPTION		SHIPPING WEIGHT
Normally Open or Normally Closed		Cable Length	Mounting Device	
1006111		3 Meters	Mounting Clamp	0.54 kg
1006116		3 Meters	Cable Weight	1.30 kg
1006112		5 Meters	Mounting Clamp	0.78 kg
1006117		5 Meters	Cable Weight	1.54 kg
1006113		6 Meters	Mounting Clamp	0.90 kg
1006118		6 Meters	Cable Weight	1.66 kg
1006114		10 Meters	Mounting Clamp	1.37 kg
1006119		10 Meters	Cable Weight	2.14 kg

Normally Open (High Level) Operation - The control switch closes (turns on) when the switch tips slightly **above** horizontal signaling a high level, and opens (turns off) when the switch drops slightly **below** horizontal in water or sewage applications.

Normally Closed (Low Level) Operation - The control switch closes (turns on) when the switch drops slightly **below** horizontal signaling a low level, and opens (turns off) when the switch tips slightly **above** horizontal in water or sewage applications.

SJE SignalMaster® SPDT pump switch has 3 conductors for normally open or normally closed operation.

SEE INTERNATIONAL PRICE BOOK FOR LIST PRICING.

OPTIONS

Bagged Packaging is standard.

CE Certified units available upon request.



SJE RHOMBUS

www.sjerrhombus.com

customer.service@sjeinc.com